



111th ANNUAL

Fall Conference & Trade Show

OCTOBER
13-15, 2023

THE HOTEL
AT AVALON
Alpharetta



Gold



Bronze



Silver



Conference Sponsors





2023 BOARD

Dr. Ben McDowell
President

Dr. Deborah Little
President-Elect

Dr. Noel Steinle
Past-President

Dr. Leana Kart
Treasurer

Dr. Nailah Smith
Secretary

Dr. Kellie Baxter
Director

Dr. Philip Day
Director

Dr. Johnny Garcia
Director

Dr. Anissa Jones
Director

Dr. Karen Mathiak
Director

Dr. Lesli Walker
Director

STAFF

Valerie L. Smith, CAE
Executive Director

Diane Hamby
Director of Membership
& Operations

SeKoixa Gonzalez
Communications &
Events Coordinator

Aubrey Villines, J.D.
General Counsel

Welcome to the 111th Annual GCA Fall Conference & Trade Show

Dear Attendees, Exhibitors, Sponsors and Friends,



If you're attending GCA's 111th Annual Fall Conference & Trade Show then I have some great news for you! YOU, and yes I do mean YOU, are in the RIGHT place, at the RIGHT

time! In addition to some awesome CE, we have lots of fun networking events planned.

We're excited to offer a wide variety of speakers this year. Friday we are featuring sessions on hands-on neck adjusting, pediatrics and nutrition; Saturday we'll have hands-on extremity and spine adjusting, outcome-based tools for patients at all stages of life, risk management and law; while Sunday will feature even more adjusting and an exploration of glucose dysregulation and its impact on chronic diseases.

Find more information on the class schedule and our great speakers later in this program.

We've also planned plenty of opportunities for you to network and have some fun! Friday night we'll have our Egyptian-themed Vendor Reception, and Saturday I'll be hosting our annual awards luncheon. For our women D.C.s, be sure to check out the Ladies' Tea on Saturday at 3:30 PM, honoring Life University's Provost Dr. Jana Holwick.

Finally, please make your plans to attend both the GCA Annual Meeting (1-2:30 p.m., Friday) and the Political Action Committee Meeting (5:30-6:30 p.m., Saturday). These are the best ways to learn not only why membership in BOTH are ESSENTIAL but also what your association has accomplished to date and what our plans are for the future.

Please join me in thanking our Conference Committee, headed by co-chairs Dr. Anissa Jones and Kellie Baxter. These women and the rest of the committee have done an amazing job,

ensuring our conference offers plenty of opportunities for fun! Also, thank you to Dr. Karen Mathiak and the Education Committee for choosing our diverse speaker lineup. If you see them, please thank them. I also want to thank our conference exhibitors, sponsors and GCA partners – their support has helped us create bigger and better events each year!

And finally, thank you, GCA members! Your participation is vital to the association as we continue to promote the chiropractic profession in Georgia.

And if you're not currently a member ... have you asked yourself why not? Furthermore, have you voiced those questions you have about what benefit the GCA provides to you, or what the GCA has done for you lately, or how the GCA can help you grow your business to me or someone else on the board to get an answer?

If we want to improve chiropractic and help chiropractors, then we must band together. Gone are the days of fighting over petty disagreements. The fact of the matter is that if we had even 50% of the chiropractors as members of the association and the PAC, it would catapult us into the next level! 80% would be a paradigm shift.

If you turn in your membership application and pay-in-full by noon on Sunday, your membership will be good through Dec. 31, 2023. You can find an application in your attendee packet as well as at our registration booth. Don't leave this weekend without doing this; it is vital to the protection and promotion of today as well as the future of our profession.

Till next time, let's let 'em have it.



Benjamin Scott McDowell,
D.C., B.C.A.O.
GCA President

Schedule

FRIDAY, OCT. 13

7 A.M.-6:30 P.M.
SKELTON

Registration open

8 A.M.-7:30 P.M.
SKELTON

Trade show open

8 A.M.-NOON
TEASLEY 2,3

Clinical Science: Chiropractic Nutrition and Adapting to the Ever-Changing Environment

Dr. Dan Murphy

Sponsored by Nutri-West

8 A.M.-NOON
TEASLEY 4, 5, 6

Clinical Science: Developmental Care of the Pediatric Patient

Dr. Laura Hanson

8 A.M.-NOON
BRADY

Clinical Science: Pediatric and Adult CPR

(additional fee; must be pre-registered)

10:15-10:45 A.M.
SKELTON

Refreshment break

NOON-1 P.M.

Lunch (Pre-ordered boxed lunches may be picked up in Skelton)

1-2:30 P.M.
DODD

GCA's Annual Business Meeting

2:30-6:30 P.M.
TEASLEY 2, 3

Clinical Science: Chiropractic Nutrition and Adapting to the Ever-Changing Environment

Dr. Dan Murphy

Sponsored by Nutri-West

2:30-6:30 P.M.
TEASLEY 4, 5, 6

Clinical Science: Sensory Motor Integration and Neck Subluxations

Dr. Marc Ellis

4:30-5 P.M.
SKELTON

Refreshment break

Sponsored by The Brown Firm

6:30-7:30 P.M.
SKELTON

Egyptian Vendor Reception

Sponsored by 100 Year Lifestyle,

Michael E. Carroll & Associates,
CP Healthcare, Elite Radiology of
Georgia, Georgia Spine & Orthopaedics
and Samuel Johnson & Associates.

7:30-10 P.M.
SUITE 200

President's Suite Open

SATURDAY, OCT. 14

7 A.M.-5:30 P.M.
SKELTON

Registration open

8 A.M.-5:30 P.M.
SKELTON

Trade show open

8-9 A.M.
BRADY

Advanced C.A. Class Test

Dr. Jack Brink

8 A.M.-NOON
TEASLEY 1

Risk Management: The Essential Chiropractor – for D.C.s AND C.A.s

Dr. Eric Plasker

10:15-10:45 A.M.
SKELETON

Refreshment break

NOON-1 P.M.
TEASLEY 1

Georgia Law – for D.C.s AND C.A.s

Mr. Aubrey Villines

1-2:30 P.M.
SKELTON

President's Luncheon & Awards Ceremony

Sponsored by Ameris Bank, Barbour Orthopaedics, Georgia Pain & Spine Institute, Life University, North Atlanta Spine & Pain Care and Thrive Ortho & Spine

2:30-5:30 P.M.
TEASLEY 2, 3

Clinical Science: Mastering the Lower Extremities and Spine the Wong Way, Part I

Dr. Kevin Wong

Sponsored by Foot Levelers

2:30-5:30 P.M.
TEASLEY 4, 5, 6

Clinical Science: Getting to Optimal for Each Patient

Dr. Stephanie Sullivan, Dr. Dominic Fetterly, Dr. Tyson Perez, Dr. Keith Rau and Ms. Emily Drake

Sponsored by Life University

2:30-5:30 P.M.
BRADY

C.A. Class: Marketing Panel

Ms. Lauire Simpson, CCA, CCCPC;
Ms. SeKoixa Gonzalez; Mr. Axel Martinez

3:30-4 P.M.
SKELTON

Refreshment break

3:30-5 P.M.
HAGOOD

Ladies' Tea honoring Dr. Jana Holwick

Sponsored by NCMIC

5-5:30 P.M.
TRAMMEL/DEVORE

Advanced C.A. Class Graduation

5:30-6:30 P.M.
DODD

GCA Political Action Committee meeting

6:30-10 P.M.
SUITE 200

President's Suite Open

SUNDAY, OCT. 16

7:30 A.M.-NOON
SKELTON

Registration open

8 A.M.-NOON
SKELTON

Trade show open

8 A.M.-NOON
TEASLEY 2, 3

Clinical Science: Mastering the Lower Extremities and Spine the Wong Way, Part II

Dr. Kevin Wong

Sponsored by Foot Levelers

8 A.M.-NOON
TEASLEY 4, 5, 6

Clinical Science: Beyond Diabetes: Clinical and Public Health Perspectives on Glucose Regulation and Chronic Disease

Dr. Paul Goldberg

8 A.M.-NOON
BRADY

C.A. Class: Team Building

Dr. Jack Brink

10:15-10:45 A.M.
SKELTON

Refreshment break

Meet the Speakers



Dr. Jack Brink



Ms. Emily Drake

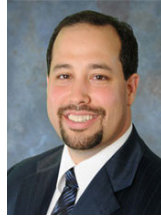

Dr. Marc Ellis



Dr. Dominic Fetterly



Dr. Paul Goldberg



Ms. SeKoixa Gonzalez



Dr. Laura Hanson



Mr. Axel Martinez



Dr. Dan Murphy

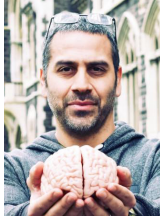

Dr. Tyson Perez



Dr. Eric Plasker



Dr. Keith Rau



Ms. Laurie Simpson



Dr. Stephanie Sullivan



Mr. Aubrey Villines



Dr. Kevin Wong

Jack Brink, D.C.

Dr. Jack Brink ran a long time practice in Atlanta and has been the lead instructor of GCA's Advanced Chiropractic Assistant Program for 35 years.

Emily Drake, M.S.

Ms. Emily Drake is a research scientist at the Dr. Sid E. Williams Center for Chiropractic Research at Life University. She currently leads a team of investigators interested in understanding more about the influence of chiropractic care on the brain and body.

Marc Ellis, D.C., D.A.C.N.B., F.A.C.F.N., F.A.B.B.I.R.

Dr. Marc Ellis has been in practice more than 20 years and is an assistant professor at the Carrick Institute for Graduate Studies and an instructor at Gwinnett College. He is a specialist in Chiropractic Neurology and is the developer of Myosynaptics.

Dominic Fetterly, D.C., D.A.C.N.B.

Dr. Dominic Fetterly is the director of the NeuroLIFE Institute at Life University, where he treats complex neurological conditions.

Paul A. Goldberg, B.A., B.S. M.P.H., D.C., D.A.C.B.N., D.C.B.C.N.

Dr. Paul Goldberg is the founder of The Goldberg Tener Clinic for Chronic Disease Reversal that focuses on autoimmune conditions, digestive disorders and reversal of degenerative diseases, using clinical epidemiology, chiropractic and clinical nutrition as well as a former Life University Faculty member.

SeKoixa Gonzalez

Ms. SeKoixa Gonzalez is the Communications and Events Coordinator for the Georgia Chiropractic Association. A graduate of Georgia State University, she has taken GCA's social media to the next level with the use of graphics and video.

Laura Hanson, D.C., QEEG-DL, D.I.C.C.P., N.D.T., B.C.N., C.A.S.

Dr. Laura Hanson is an integrative practitioner who has designed and directed innovative programs, spearheaded research and delivered post-doctoral lectures to advance comprehensive treatments for pediatric and specialized populations.

Axel Martinez

Mr. Axel Martinez has been the office manager of Northwest Chiropractic for over five years. A graduate of St. John's University, in addition to running the office, he handles marketing for the clinic.

Dan Murphy, D.C.

In practice for 45 years, Dr. Dan Murphy has taught nearly 2000 postgraduate continuing education courses across the country in biomechanics, soft tissue injury and repair, pain and proprioceptive neurology and clinical nutrition.

Tyson Perez, D.C., Ph.D.

Dr. Tyson Perez is a neuroscientist at the Dr. Sid E. Williams Center for Chiropractic Research at Life University. He also teaches research at the university.

Eric Plasker, D.C.

Chiropractor, author and speaker Dr. Eric Plasker has been in practice for 37 years, treating newborns through seniors.

He is the author of the bestselling book *The 100 Year Lifestyle* and an evangelist for chiropractic care.

Keith Rau, D.C., C.C.E.P., C.C.S.P.

Dr. Keith Rau is an associate professor in the Sport Health Science Department and formerly the Director of Sports Chiropractic for Life University's Athletic Department.

Laurie Simpson, CCA, CCCPC

Ms. Laurie Simpson is the Director of Operations for Parkridge Healthcare and Physical Medicine. She is a former instructor for GCA's Advanced Chiropractic Assistant Program and has spoken throughout the Southeast.

Stephanie Sullivan, D.C., Ph.D.

Dr. Stephanie Sullivan is the Director of the Dr. Sid E. Williams Center for Chiropractic Research. Her research interests include cognitive efficiency and the effect of chiropractic and applied clinical neuroscience care on brain-body neuroplasticity.

Aubrey Villines, J.D.

Mr. Aubrey Villines has been GCA's attorney and lobbyist for 44 years and has helped shape many of the laws affecting chiropractic in Georgia.

Kevin Wong, D.C.

Dr. Kevin Wong has been a Foot Levelers speaker for nearly 20 years, teaching hands-on adjusting techniques for the whole body.

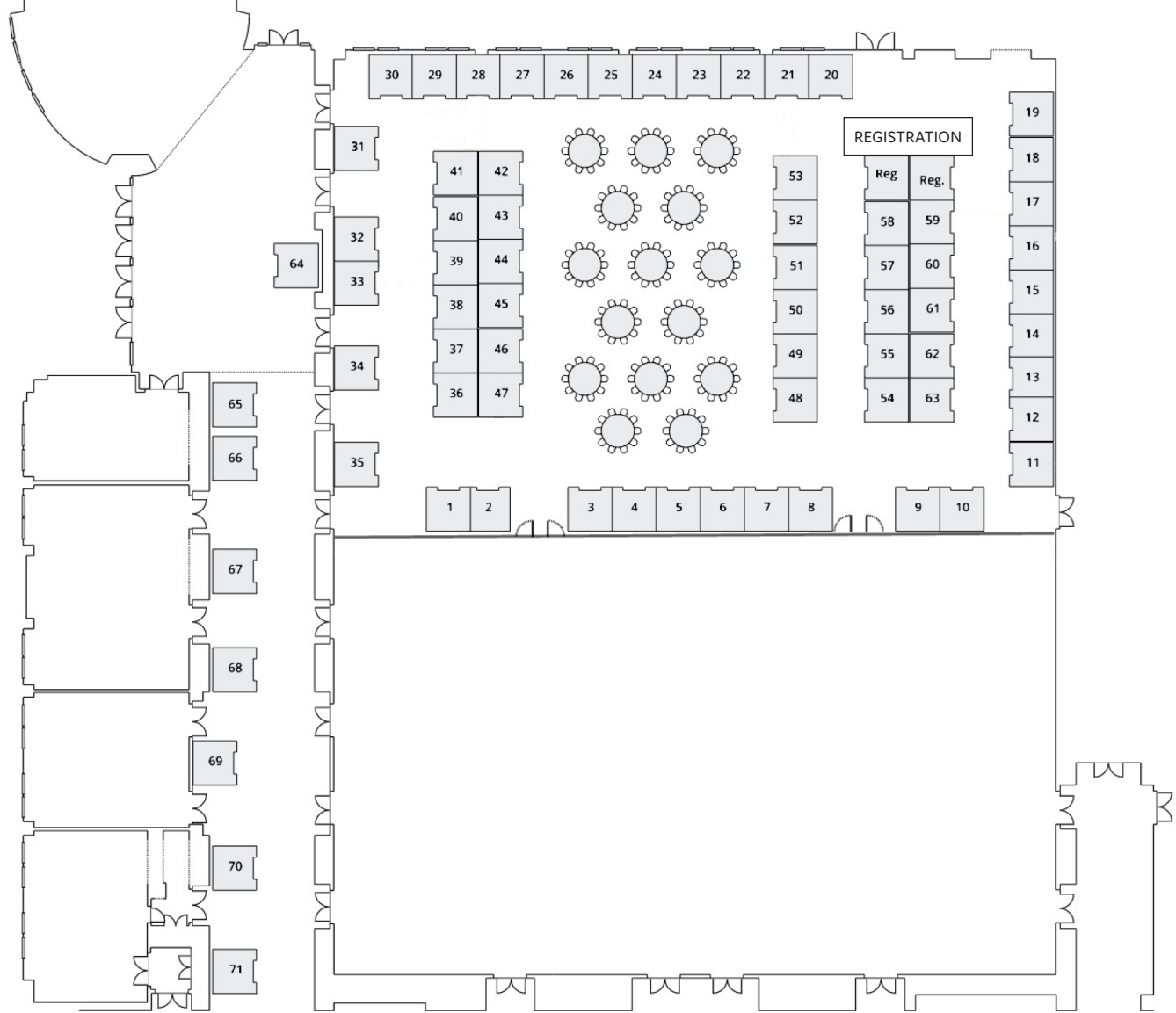

Exhibitors

- | | | | | |
|--|---|--------------------------------|--------------------------------------|---------------------------------------|
| 1-2 BARBOUR
ORTHOPAEDICS | 16-17 GCA-POLITICAL
ACTION COMMITTEE | 31 ADVANCED IMAGING
CENTERS | 45 LIGHTYEAR FUNDING | 60 AMERICAN HEALTH
IMAGING CENTERS |
| 3 NORTH ATLANTA SPINE
& PAIN CENTER | 18 CHIROPREFERRED | 32 PROSOURCE FIT | 46-47 SAMUEL JOHNSON
& ASSOCIATES | 61 AP HEALTHCARE |
| 4-5 CHIRO1SOURCE | 19 MICHAEL E. CARROLL &
ASSOCIATES | 33 HOPE IMAGING CENTER | 48 PROLEVE | 62 CHIROTEL MED |
| 6 HIDOW INTERNATIONAL | 20 AMERIS BANK | 34 LIFE UNIVERSITY | 49 MASSEY LAW | 63 MEDICAL MARVEL
MASSAGE CHAIRS |
| 7 ELITE RADIOLOGY | 21 DSI EV SOLUTIONS | 35 THRIVE ORTHO & SPINE | 50 NUTRI-DYN | 64 STANDARD PROCESS |
| 8 CAMBRE & ASSOCIATES | 22 MI-TRAC | 36 NUTRI-WEST | 51 RICKARD, DREW & NIX | 65 GEORGIA PAIN &
SPINE INSTITUTE |
| 9 HOLISTIC PROBLEM
SOLVER | 23 PEACHTREE
ORTHOPEDECS | 37 CAB MEDICAL | 52 MRI IMAGING
SPECIALISTS | 66 Z-TEK |
| 10 STARKS BYRON | 24 KINAS MEDICAL | 38 EVERYDAY CARDIO CARE | 53 FOOT LEVELERS | 67 ALL STATE MEDICAL |
| 11 BRYTE PAYMENT
SOLUTIONS | 25 CARE WEAR CORP. | 39 BROOKHAVEN
MORTGAGE TEAM | 54 GEORGIA SPINE & OR-
THOPAEDICS | 68 GREATHOUSE TRIAL LAW |
| 12 RS MEDICAL | 26 LEGACY BRAIN & SPINE | 40 ELVATION MEDICAL | 55 PROTEC SPINE | 69 NUMEDICA |
| 13 MULTI RADIANCE
MEDICAL | 27 SCAN.COM | 41 APEX ENERGETIX | 56 VIZISITES | 70 SY MANAGE PAIN
SUPPLIES |
| 14 PULSE PEMF | 28 TRAUMA NEUROCARE | 42 CAPITAL X-RAY | 57 THE 100 YEAR LIFESTYLE | 71 NEXGEN MEDICAL
CENTERS |
| 15 THE BROWN FIRM | 29 USA ORTHOPAEDICS | 43 ECLIPSE EHR | 58 OMNI HEALTHCARE | |
| | 30 CP HEALTHCARE | 44 PHYTOMANA CBD
PRODUCTS | 59 SPINE CENTER ATLANTA | |

Very Important People

Past Presidents

- * Dr. Walter Bowden 1926-27
- * Dr. Michael Gerhson 1927-32
- * Dr. Cecil Straight 1932-33
- * Dr. L. J. C. Williamson 1934-35
- * Dr. H. E. Stanford 1936-37
- * Dr. Virgil Lake 1940-43
- * Dr. Dan Leigh 1943-44
- * Dr. Elmo Davis 1944-45
- * Dr. O. B. Inman 1945-47
- * Dr. William M. Harris 1947-48
- * Dr. E. C. Sowers 1948-50
- * Dr. E. R. Strickland 1950-52
- * Dr. L. O. Shaw 1952-53
- * Dr. R. T. Leiter 1953-55
- * Dr. William H. Allen 1955-57
- * Dr. H. B. Duke 1957-58
- * Dr. R. Griffin 1958-59
- * Dr. T. O. Humber 1959-60
- * Dr. Hugh Crowe 1960-61
- * Dr. C. W. McHan 1961-62
- Dr. R. K. Wright 1962-63
- * Dr. R. J. Clark 1963-64
- * Dr. R. J. Brown 1964-65
- * Dr. G. D. Stephenson 1965-66
- * Dr. H. L. Foley 1966-67
- * Dr. R. W. Sweat 1967-68
- * Dr. J. T. Boutwell 1968-69
- * Dr. W. R. Dyer 1969-70
- * Dr. C. M. Grogan 1970-71
- * Dr. Deane Mink 1971-72
- Dr. D. D. Humber, Sr. 1972-73
- * Dr. Clarke Harkins 1973-74
- * Dr. Mildred L. Kimbrough 1974-75
- * Dr. D. N. Parkerson 1975-76
- * Dr. John Ellis 1976-78
- * Dr. Eugene Sparlin 1978-80
- * Dr. Ray L. Thomas 1980-82
- * Dr. Jerry D. Chastain 1982-84
- * Dr. William H. Vaughn 1984-86
- Dr. Albert Babel 1986-88
- * Dr. Walter C. Fowler 1988-90
- Dr. Thomas J. Kirchofer 1990-91
- Dr. G. B. Holsonback 1991-93
- Dr. Albert Babel 1993-95
- Dr. Ralph J. Templeton 1996-98
- * Dr. John Glaccum 1999-2000
- Dr. A. A. Culbreth 2001-2003
- Dr. Robert A. Hayden 2004-2006
- Dr. Kathryn A. Webb 2007-2008
- Dr. Philip Day 2008-2010
- Dr. Richard Gadd 2010-2012
- Dr. Douglas Giles 2012-2013
- Dr. Edward Cordovado 2013-2014
- Dr. Charles Weiss 2014-2015
- Dr. Edwin Davis, Jr. 2015-2016
- Dr. Richard Buchanan 2016-2017
- Dr. Leana Kart, 2017-2018
- * Dr. Clark Stull, 2018-2019
- Dr. Michael Vaughn, 2019-20
- Dr. Vince Erario, 2020-21
- Dr. Noel Steinle, 2021-22
- Dr. Benjamin McDowell, 2022-23

Chiropractor of the Year

- * Dr. Clay L. Dean 1954
- * Dr. R.T. Leiter 1955
- * Dr. Ernestine Parker 1957
- * Dr. William Griffin 1958
- * Dr. N.C. Brown 1959
- * Dr. Irving Rose 1961
- * Dr. W.R. Griffin 1962
- * Dr. William Harris 1963
- * Dr. J.W. Stanford 1964
- * Dr. George C. Paulk 1965
- * Dr. W.H. Allen 1966
- * Dr. O.B. Inman 1967
- * Dr. Sid Williams 1968
- * Dr. W.L. Hall 1970
- * Dr. Cecil Grogan 1971
- * Dr. Mildred L. Kimbrough 1972
- * Dr. John Boutwell 1973
- Dr. D.D. Humber 1974
- * Dr. Hazel Cotney 1976
- * Dr. Charles Methvin 1977
- * Dr. Joe G. Bishop 1978
- * Dr. Stan Merica 1979
- * Dr. Ed Bateson 1987
- Dr. W. David Hall 1988
- Dr. Richard Gadd 1989
- * Dr. Kevin Robinson 1990
- Dr. Earl Beck 1991
- * Dr. Ray Thomas 1992
- * Dr. Eugene Sparlin 1993
- Dr. G. B. Holsonback 1994
- Dr. A. J. Babel 1995
- * Dr. Russell Erhardt 1996
- * Dr. Weldon Odom 1997
- Dr. Ralph Templeton 1998
- Dr. Andrew Kirk 1999
- Dr. Abner Salas 2000
- * Dr. Deane Mink 2001
- Dr. Patrick Sallarulo 2002
- Dr. Vince Erario 2003
- * Dr. Jeff Slocum 2004
- Dr. Davis Kinney 2005
- Dr. Robert Hayden 2006
- Dr. Edward Cordovado 2007
- Dr. Kathryn Webb 2008
- Dr. A. A. Culbreth 2009
- Dr. Philip Day 2010
- Dr. Mark Cotney 2011
- Dr. Mary Watkins 2012
- Dr. Douglas Giles 2013
- Dr. Steven Barnett 2014
- Dr. Charles Weiss 2015
- Dr. Leana Kart 2016
- Dr. Karen Mathiak 2017
- Dr. Richard Buchanan, 2018
- Dr. Chris Connelly, 2019
- Dr. Noel Steinle, 2020
- Dr. Randy Mayfield, 2021
- Dr. Michael Vaughn, 2022

Lifetime Achievement

- * Dr. Ray Thomas 1998 *1st recipient*
- * Dr. Ed Bateson 1999
- * Dr. Eugene Sparlin 2001
- * Dr. Roy Sweat 2003
- * Dr. John Proctor 2005
- * Dr. Hazel Cotney 2007
- * Dr. Deane Mink 2011
- * Dr. John Ellis 2013
- Dr. David Wren, 2017
- Dr. Leana Kart, 2019
- Dr. Mary Watkins, 2021

**Deceased*

Thank You

GCA-PAC and Legal Action Fund Contributors

The GCA-PAC supports pro-chiropractic political candidates and legislators by making campaign donations. The Legal Action Fund is reserved for possible litigation to protect YOUR right to practice. Join us in thanking the following donors, and find more information about adding your names to these lists in your attendee packet.

GCA-PAC

Platinum Leader - \$10,000+

Dr. Harry Brown Sr.

Patron - \$5,000 +

Dr. Harry Brown Jr.

Ambassador - \$3,500

Dr. Jonathan Jewett

Dr. Dawn Samad

Founders Club - \$1912+

Dr. Jared Brown

Dr. Leana Kart

Dr. J. Ryan Moorman

Mr. Daniel Nagel

Dr. Sebastian Salomone

Dr. Mary Watkins

Dr. David Webb

President's Circle - \$1,000+

Dr. Khaled Abouhaif

Dr. Jeff Appelbaum

Dr. Dr. Jim Aspinwall

Dr. Sherry Bramlett

Dr. Don Capoferri

Dr. Winston Carhee

Dr. Ahmad Davari

Dr. Robert DeBease

Dr. Jay DiVagno

Dr. Andrew Hartpence

Dr. Gerald Holsonback

Dr. Anissa Jones

Dr. Eric Larson

Dr. Mark Lentchner

Dr. Brandon Linker

Dr. Deborah Little

Dr. Karen Mathiak

Dr. Arthur Matthews

Dr. Christopher McCracken

Dr. Deane Mink

Dr. Fredrick Neal

Dr. James Nelson

Dr. Kenneth Register

Dr. Guy Riekeman

Dr. Nailah Smith

Dr. Noel Steinle

Dr. Michael Vaughn

Dr. Michael Waldrop

Dr. Gregory Wheeler

Dr. David Wren

Proleve Distribution

Advocate - \$500+

Dr. Mark Anthony

Dr. Elizabeth Banks

Dr. Brad Bootstaylor

Dr. Alonzo M. Borja

Dr. Philip Day

Dr. John Duke

Dr. Vincent Erario

Dr. Joseph Fowler

Dr. Raymond Fowler

Dr. Paul Goldberg

Dr. Matthew Hamby

Dr. Todd Hanscom

Dr. Michael Maiorino

Dr. Landin Marzolf

Dr. Ben McDowell

Dr. James Nessing

Dr. David Noonan

Dr. David Paxton

Dr. Shoanmarie Pope

Dr. Bruce Salzinger

Dr. Karl Schwartz

Dr. Trek Smith

Dr. Ralph Templeton

Dr. David Tener

Dr. Howard Wasdin

Dr. Michael Wax

Dr. Kathryn Webb

Mr. Dominique Welsh

Dr. Brandon Williams

Primary - \$250+

Dr. Raymond Alexander

Dr. Anthony Arena

Dr. David Avard

Dr. Christopher Baggett

Dr. Natasha Balbas-Warren

Dr. Amir Banishahi

Dr. Kellie Baxter

Dr. Michael Beres

Dr. Melodie Billiot

Dr. Thomas Bombery

Dr. Annette Boone-Hicks

Dr. Antoine Brooks

Dr. Samantha Brooks

Dr. Harry Broyles

Dr. Heather Casey

Dr. Johanna Cole

Dr. Zeudiann Coleman

Dr. Alphonso Colucci

Dr. Kevin Crowder

Dr. John Crowley

Dr. Marc D'Andrea

Dr. Stacey Davis

Dr. Diane Dicker

Dr. John Dull

Dr. Sten Ekberg

Dr. Marc Ellis

Dr. Lindsey Farrell

Dr. Kenneth Flint

Dr. Johnny Garcia

Ms. Angela Getter

Dr. Robert Grace

Dr. Patrick Greco

Dr. Ted Greve

Dr. W. David Hall

Dr. Laura Hanson

Dr. Darnell Howard

Dr. Anthony Imbesi

Dr. Twila Jones

Dr. Kelley Kawamoto

Dr. Timothy Kelly

Dr. Andrew Kirk

Dr. Charles Krieger

Dr. Philip Lawrence

Dr. Seung Lee

Dr. Kim Lombardy

Dr. Joel Margolies

Dr. Jennifer McGehee

Dr. Nikki McHenry

Dr. Antonina McKay

Dr. Misael Melendez

Dr. Anthony Merati

Mi-Trac LLC

Dr. Sidney O'Gorman

Dr. Hyung Pak

Dr. Mark Patrick

Dr. Joshua Paxton

Dr. George Petryk

Dr. Eric Plasker

Dr. Kerith Powell

Dr. Duncan Regan

Dr. Dan Ribley

Dr. Lisa Richter

Dr. Tiffany Ringfield

Dr. Stacey Roberts

Dr. Juan Rodriquez

Dr. Jason Rueggeberg

Ms. Valerie Smith

Dr. Kimberly Smith-Howard

Dr. Brad Steinle

Dr. Larry Steinle

Dr. Michael Stewart

Dr. Amber Stokes

Dr. Lee J. Strickland

Dr. Stephanie Sullivan

Dr. Valerie Sylvester

Dr. Tabitha Todd

Dr. Timothy Kelly

Dr. Aimee Trust

Dr. Lesli Walker

Dr. Malcolm Warren

Dr. Amanda Watson

Dr. Bart Wetherington

Dr. Chris Whelan

Dr. Shandreika Yearwood

Legal Action Fund Contributors

Dr. Jeff Appelbaum

Dr. Mark Anthony

Dr. Linda Denham

Dr. Tony Denmark

Dr. Jay DiVagno

Dr. Andrew Hartpence

Dr. Ralph Templeton

Dr. Mary Watkins



The Relentless Representation You Deserve.
The Medical Insight You Need.



PERSONAL
INJURY



MOTORCYCLE
ACCIDENTS



AUTO
ACCIDENTS



TRUCK
ACCIDENTS



Harry Brown, Jr., DC, JD

As an attorney and chiropractor, Harry Brown, along with his team of attorneys, provide compassionate, unparalleled service throughout Georgia and South Carolina.

800-LAW-1441

ProtectingTheInjured.com

WITH OFFICES IN: Savannah, GA | Atlanta, GA | Athens, GA | Bluffton, SC